



## One Touch™ 5 Channel Remote Control Instructions

One Touch™ 5 Channel  
Remote Control Instructions

Set-up and operation

REMOTE TRANSMITTER

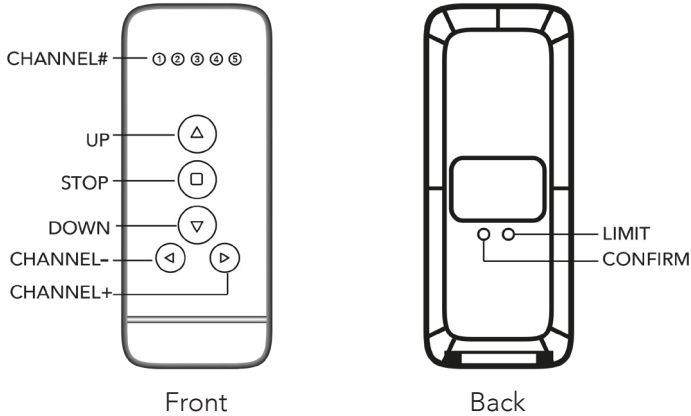

1. Select the channel for programming

Press "CHANNEL▶ " or "CHANNEL◀ " to choose the channel until the LED highlights on the channel you want.

2. Follow 'Pairing the remote with the motor' on your One Touch™ 1100 series remote control operated battery motor instructions - R1710.

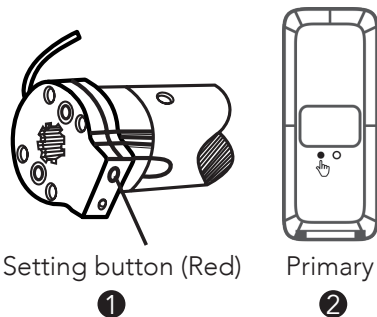

PAIRING THE REMOTE WITH THE MOTOR  
REMOVE ALL PRESET LIMITS.

1. Hold down the SETTING button on the motor until it jogs 2 times and then release the button.
2. Select the channel for the blind using the CHANNEL +/- button and press the CONFIRM button within 10 seconds. The motor will jog 2 times and the remote control is now paired with the motor.

For additional remotes repeat above steps on secondary remote transmitter.

One Touch™ 5 Channel  
Remote Control Instructions

**PLEASE NOTE:**

The group channel will be recorded on the motor automatically when the single channel has been programmed on the motor. Cycle through the channels until all the lights are lit to access the group channel on the remote.

For blind setting instruction, follow your One Touch™ 1100 series remote control operated battery motor instructions - R1710

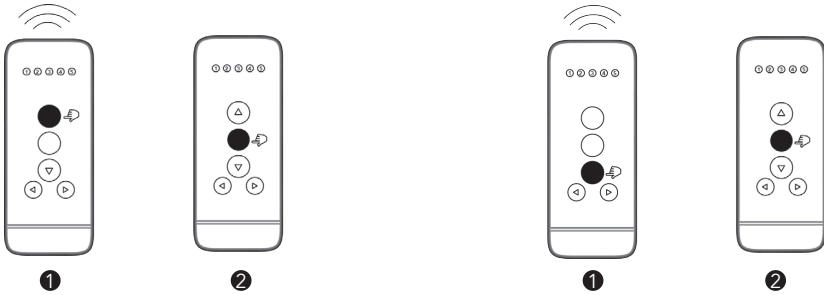

**TO RAISE THE BLIND**

1. Press **UP** button on the remote control to raise the blind.
2. Press **STOP** button on the remote control to stop the blind at desired position.

**TO LOWER THE BLIND**

1. Press **DOWN** button on the remote control to lower the blind.
2. Press the **STOP** button on the remote control to stop the blind at desired position.

**CHANGE MOTOR DIRECTION**

1. Press **UP** button on the remote control, if the blind goes up then the motor direction is okay.
2. To change the motor direction hold down the **LIMIT** button and then press **STOP** button on the remote control, the motor will jog to indicate the direction has been changed.

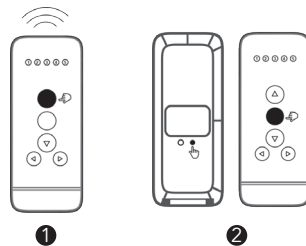

Louvolite Customer Services Tel: 0161 882 5050 Email: [sales@louvolite.com](mailto:sales@louvolite.com)  
Visit the Louvolite website to view the links to all of our fitting instructional videos  
[www.louvolite.com](http://www.louvolite.com)

