

SYSTEM 40® ROLLER SYSTEM WITH PLANETARY GEAR CONTROL

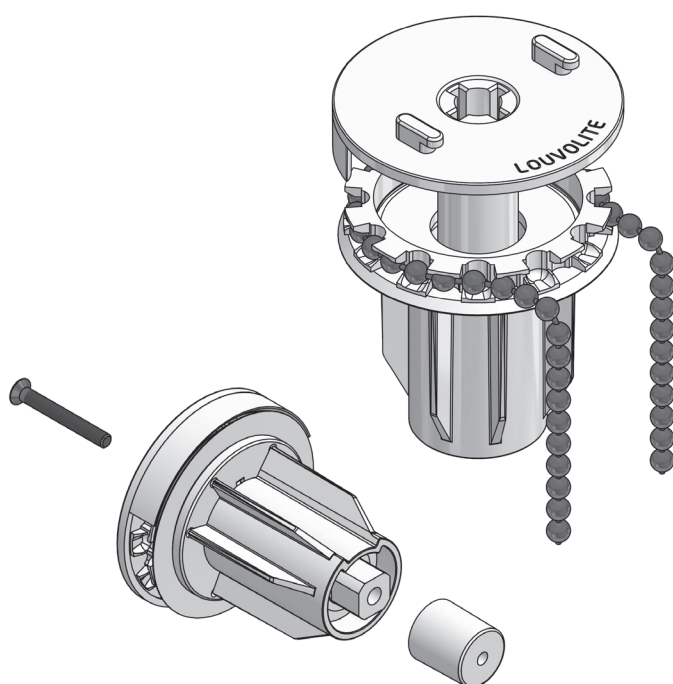
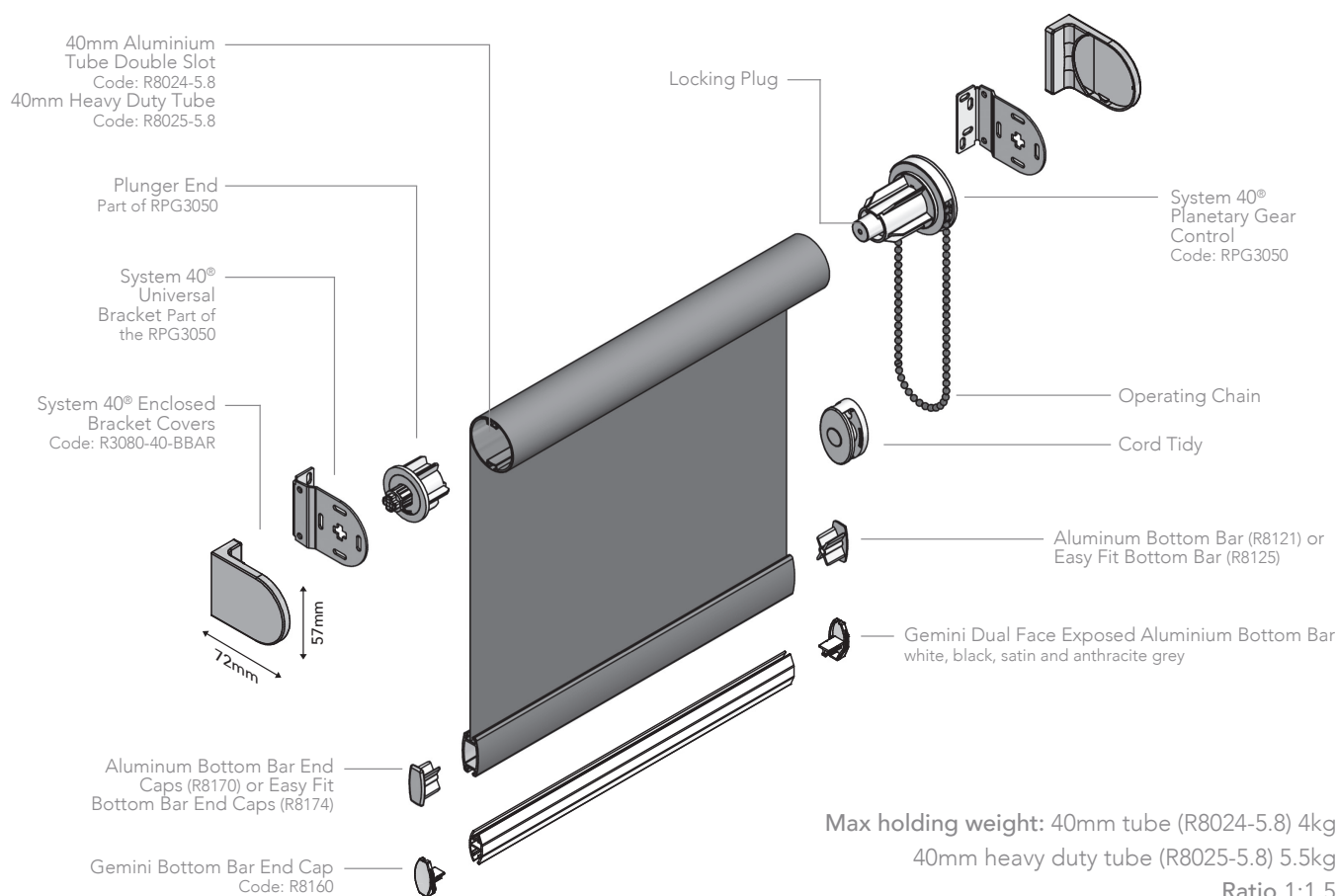

- Designed in the UK, all Louvolite systems are 10 year life cycle tested to ensure long lasting performance.
- Advanced chain location for quick and easy on-site adjustment.
- Manufactured using high quality engineering grade polymer.
- Universal brackets and a spring idle end plunger enable easy and quick installation.
- Colours available: white, beige, black and grey.

HARDWARE SPECIFICATION

System 40® Roller System

Our roller blinds are manufactured using the Louvolite System 40® roller blind mechanism with specifically designed grooved 40mm aluminium tubing. The specified fabrics are formed and held into the tube with locking tape. The planetary gear control units are made from glass filled Nylon 6.

The operating chain, in brass nickel plated, stainless steel or plastic, ensures reliable performance, and improved chain location enables quick and easy on-site adjustment. The mild steel brackets are zinc plated and powder coated, suitable for top, face or side fixing.

A spring plunger idle end mechanism is positioned

at the opposite end to the planetary gear control unit, providing a more secure fit of the blind and smooth operation.

Performance

To ensure a positive performance, all Louvolite Roller System units are designed in the UK and manufactured using prime quality plastics.

10 year life cycle testing is done to ensure long lasting performance.

Operation

Using manual or motorised operation, all blinds must be compliant with the child safety elements of BS EN13120. Where children may be present, the chain must be fitted with easybreak connectors or a cord tidy.

Bottom Bar

Made of aluminum, can be single, double or contrast fabric wrapped or left exposed. The dual face Gemini, made of aluminium, only has the fabric formed and locked into the top part to leave the bar exposed. All fabric is formed and held into place with locking tape. The dual face Gemini bar, smooth on one side and angular on the other, along with the aluminum bottom bar improves the ease of manufacture and use of thicker laminate fabrics.

Maintenance

All of the System 40® roller blind system components are manufactured using aluminium, treated steel and plastic. They do not present

any corrosion problems in normal environments. The system has been designed for a smooth operation, together with a rigidity to prolong the window blind's working life.

Additional Option: Cassette

Cassettes are specially designed and powder coated with recess, direct or face fix brackets. On specification the user has the choice between a single coloured extrusion in dedicated colours or a fascia which incorporates the same fabric or contrasting fabric used on the roller blind.

SYSTEM 40® BRACKET DIMENSIONS

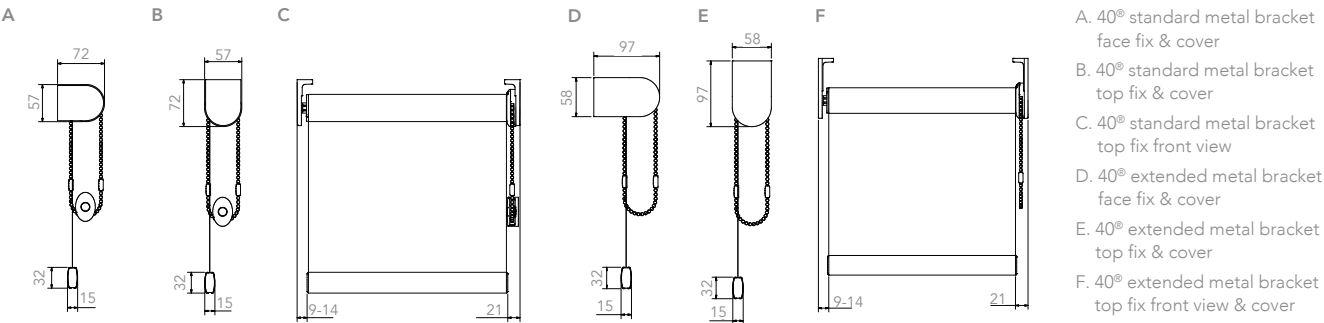

LOUVOLITE PLANETARY GEAR SYSTEM MAXIMUM BLIND SIZE

SYSTEM 40	FABRIC GROUP	BLIND WIDTH (m) FOR BLIND DROP (m)					MAX HOLDING WEIGHT
		0.5	1.0	1.5	2.0	2.5	
Performance figures based on R8024-5.8 (Standard 40mm tube)	up to 200g/m sq	5.0	5.0	5.0	5.0	5.0	4kg blind at 6mm deflection
	200 > 320g/m sq	3.75	3.75	3.75	3.75	3.75	
	320 > 485g/m sq	5.0	5.0	5.0	3.55	2.7	

* System 40® heavy duty tube (R8025-5.8) performance figures to be confirmed

Your Louvolite System 40® Distributor:



UK MANUFACTURED

www.louvolitecommercial.com

CI/SIB 1976 reference by SIB Agency		
(76.7)	X	