

SYSTEM 45® MOTORISED ROLLER SYSTEM WITH THE HARD WIRED A/C MOTOR - 1500 SERIES

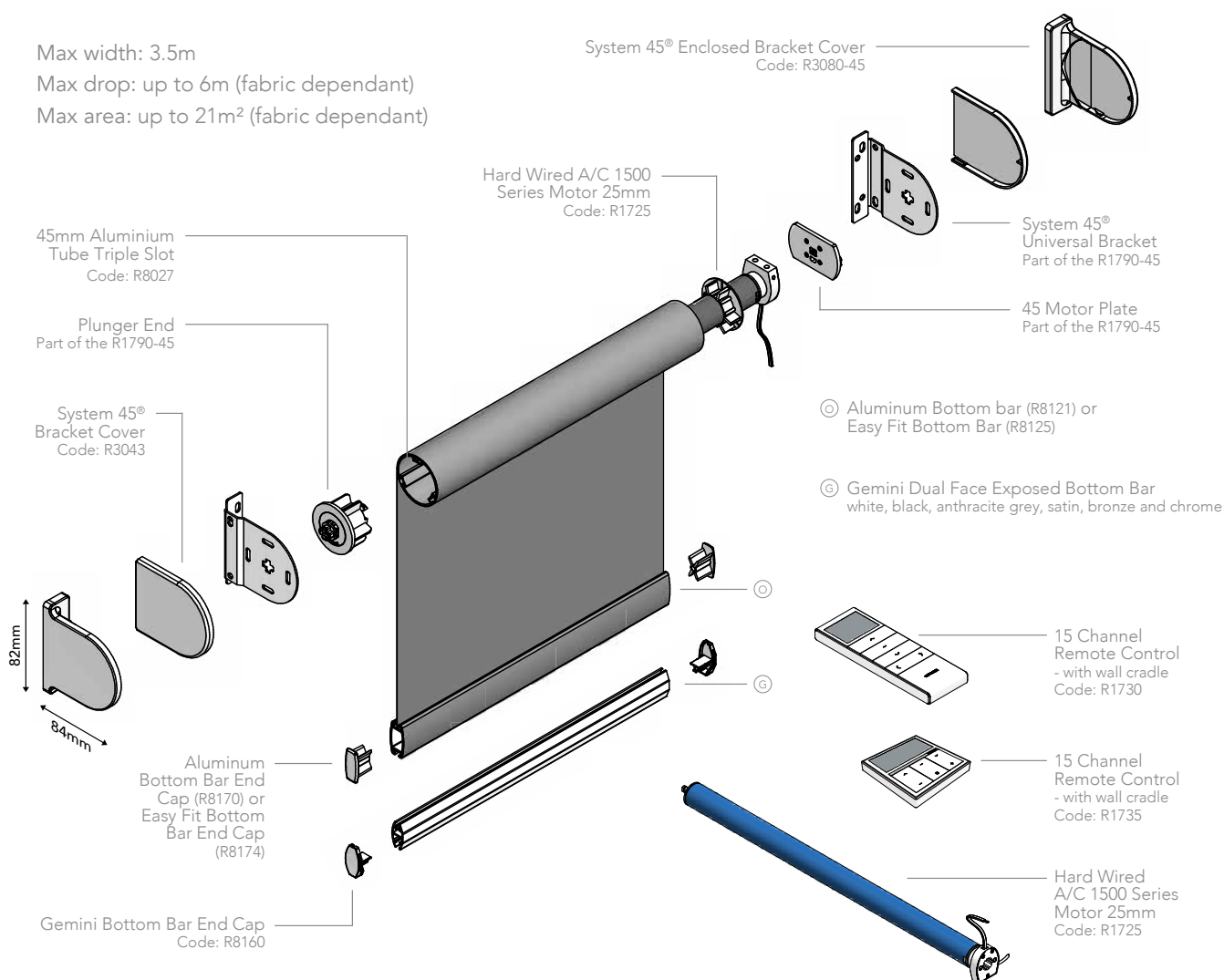

- Designed and manufactured in the UK, all Louvolite systems are 10 year life cycle tested to ensure long lasting performance.
- Operate large blinds effortlessly with Louvolite One Touch™ Hard Wired AC Motor 1500 Series.
- Manufactured using high quality engineering grade polymer.
- Universal brackets enable easy and quick installation.
- For blinds up to 3.5m wide, with a 5kg maximum holding weight.
- Limits to stop blind at highest, mid and lowest point.
- Operate up to 15 blinds, separately or simultaneously, from anywhere in the room with the 15 channel remote.
- A patented idle end adapter plate with locking body ensures the blind remains safely locked into the brackets at all times.
- For blinds up to 12kgs use 6000 Series (1740).
- Child safe by design.
- Can be operated with the Louvolite Smart Home Hub (R1764-AU). Using wifi any One Touch blinds can be operated either through the Louvolite app on a phone or tablet anywhere in the world or by voice command with Amazon Alexa, Dot, Echo and Google Pixel.
- Colours available: 45mm motor pack: white, beige and black

HARDWARE SPECIFICATION

Motorised Roller System

Our roller blinds are manufactured using the Louvolite roller blind mechanism with specifically designed grooved aluminium tubing. The specified fabrics are formed and held into the tube with locking tape. The side control units, manufactured in the UK, are made from glass filled Nylon 6, with an acetal sprocket and sprocket guard, and includes a locking spring.

The brackets are made from mild steel, zinc plated and powder coated, suitable for top, face or side fixing.

A spring plunger end

mechanism is positioned at the opposite end to the control unit, providing a more secure fit of the blind. The side control unit is fitted with a centre plug that ensures the mechanism operates smoothly even under extreme loads.

Performance

To ensure a positive performance, all Louvolite roller system units are designed and manufactured in the UK using prime quality plastic materials and a dedicated steel locking spring.

10 year life cycle testing is done to ensure long lasting performance. The units will

accept both metal or plastic operating chain providing reliable smooth operation.

Operation

Using motorised operation, all blinds must be compliant with the child safety elements of BS EN13120.

Bottom Bar

Made of aluminum, can be single, double or contrast fabric wrapped or left exposed. The dual face Gemini, made of aluminium, only has the fabric formed and locked into the top part to leave the bar exposed. All fabric is formed and held into place with locking tape.

The dual face Gemini bar, smooth on one side and angular on the other, along with the aluminum bottom bar improves the ease of manufacture and use of thicker laminate fabrics.

Maintenance

All of the roller blind system components are manufactured using aluminium, treated steel and plastic. They do not present any corrosion problems in normal environments. The system has been designed for a smooth operation, together with a rigidity to prolong the window blind's working life.

ADDITIONAL OPTIONS - CASSETTES

System 40/45® Fascia Cassette
Code: R3519/3522
white, black & grey

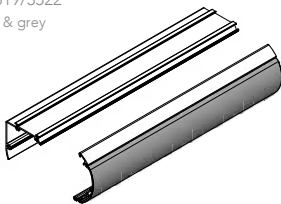

40/45 Cassette Motor Set:
R1796-45

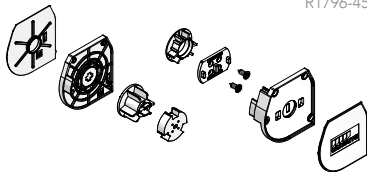

A/C MOTOR 1500 SERIES

MORE SPECIFICATIONS		FEATURES	
Rated Torque	1.5Nm	Min Blind Width	500mm
Rated RPM	32rpm		
Motor Diameter	25mm		
Rated Voltage	DC110V /230V	Weight Capacity	5kgs
Rated Power	15.3W		
Rated Current	0.13A		
IP Class	IP44	Power Source	Mains Powered
Cable	2 core		
Inbuilt Receiver	Yes		

Your Louvolite A/C Hard Wired Motorised Roller System Distributor:



UK MANUFACTURED

www.louvolitecommercial.com

CI/SIB 1976 reference by SIB Agency			
(76.7)	X		