

PLEATED LIFT SYSTEM - LOOPED CORD WITH THE 60mm CASSETTE

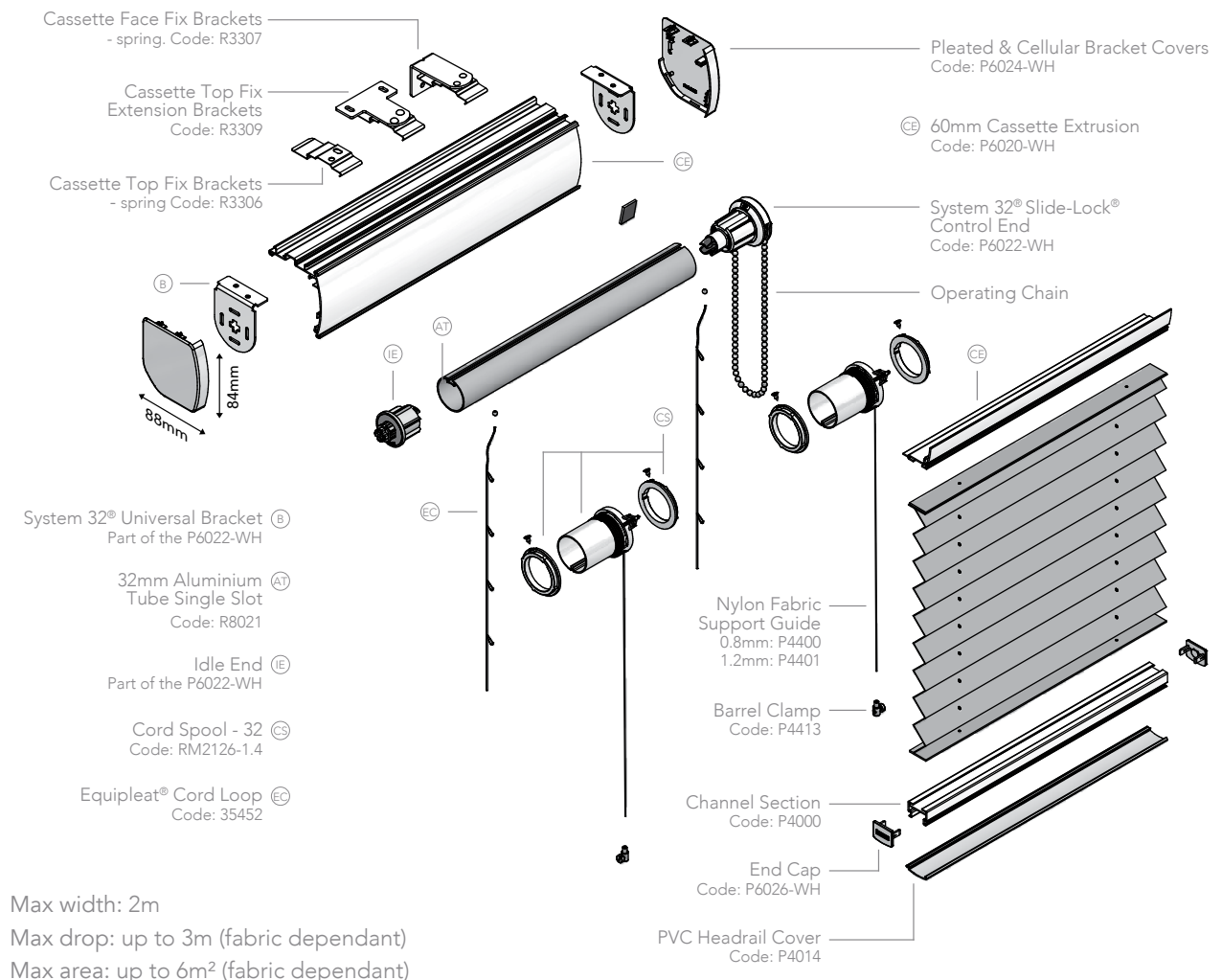

- Designed and manufactured in the UK, all Louvolite systems are 10 year life cycle tested to ensure long lasting performance.
- For blinds up to 2m wide, with a 2.72kgs maximum holding weight.
- Large pleated and cellular blinds with easy to operate manual or motorised handling options.
- Spool guides provide smooth lift capability and neatly stack the fabric under the cassette.
- 60mm headrail with curved front profile for improved aesthetics.
- System 32® Slide-Lock® combines heavier holding weights with anti-fray features that ensure enhanced blind performance.
- Improved chain location for quick and easy on-site adjustment.
- Universal brackets and a spring idle end plunger enable easy and quick installation.
- Manufactured using high quality engineering grade polymer.
- Pleated & Cellular Lift System can be motorised (Code: R1798-35) using Louvolite One Touch™ Magic wand (R1700-RH-800 or R1705-RH-800), Lithium rechargeable motor (R1710) or mains hard wired a/c motor (R1725).
- Motorised option child safe with no loose cords.
- Colours available: white.

HARDWARE SPECIFICATION

Pleated/Cellular Lift System

Our pleated/cellular blinds are manufactured using the Louvolite System 32® blind mechanism with specifically designed grooved 32 or 35mm (for motorised) aluminium tubing. The specified fabrics are formed and held into the tube with locking tape. The side control units are made from glass filled Nylon 6, with an acetal sprocket and sprocket guard.

The operating chain, No. 10 size in metal or plastic, ensures reliable performance, and improved chain location enables quick and easy on-

site adjustment. Motorised options are child safe with no loose cords. The mild steel brackets are zinc plated and powder coated, suitable for top, face or side fixing.

A idle plunger end mechanism is positioned at the opposite end to the control unit, providing a more secure fit of the blind and smooth operation.

Colour spec: White RAL 9010.

Performance

To ensure a positive performance, all Louvolite Roller System units are designed and manufactured

in the UK using prime quality plastic materials and a dedicated steel locking spring. The sidewinders will lock into the bracket with the unique bracket securing pin for safety after installation.

10 year life cycle testing is done to ensure long lasting performance.

Operation

Using manual or motorised operation, all blinds must be compliant with the child safety elements of BS EN13120. Where children may be present, the chain must be fitted with easybreak connectors or a cord tidy.

Maintenance

All of the pleated/cellular blind system components are manufactured using aluminium, treated steel and plastic. They do not present any corrosion problems in normal environments. The system has been designed for a smooth operation, together with a rigidity to prolong the window blind’s working life.

Cassette

Specially designed powder coated cassette system with top fix (recess) or face fix bracket options.

LITHIUM 1100 SERIES MOTORISED PLEATED LIFT SYSTEM - LOOPED CORD

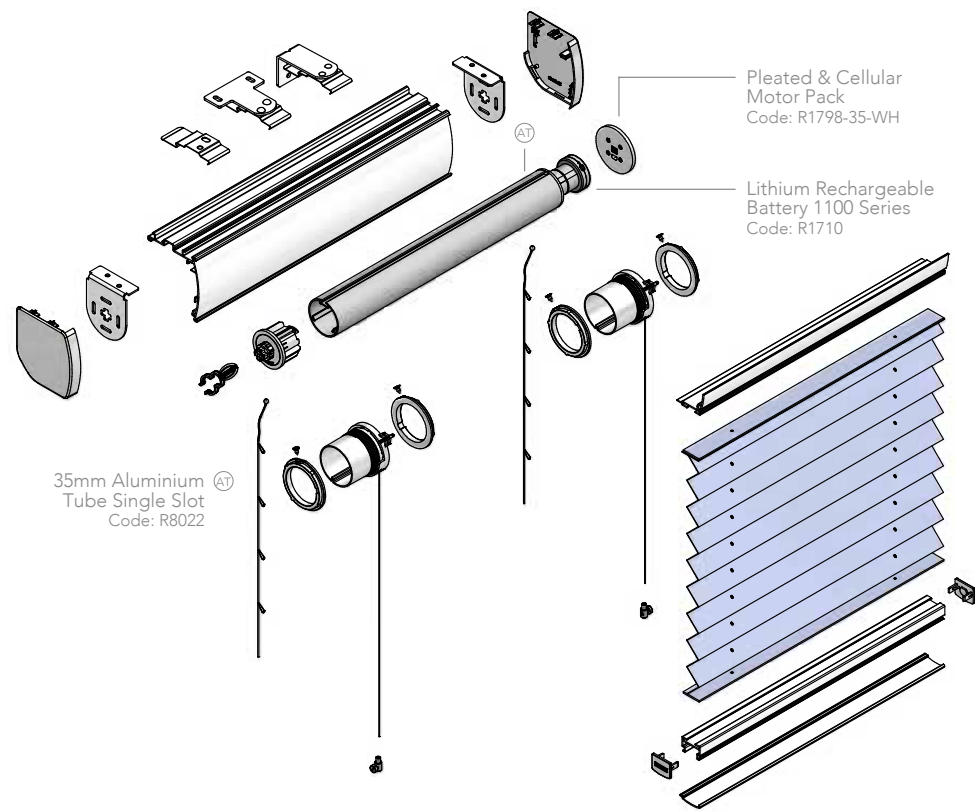

LITHIUM 1100 SERIES MOTOR

PARAMETERS	
Rated Torque	1.1Nm
Rated RPM	25rpm
Motor Diameter	25mm
Rated Voltage	DC7V
Rated Power	2W
Rated Current	0.8A
IP Class	IP40
Inbuilt Receiver	No

FEATURES	
Min Blind Width	455mm (460 with open cassette)
Weight Capacity	3kgs (2.5m x 2.7m)*
Power Source	Re-chargeable (plug-in charger or solar panel)

Your Louvolite Pleated & Cellular Blind Distributor:



UK MANUFACTURED

www.louvolitecommercial.com

CI/SIB 1976 reference by SIB Agency		
(76.7)	X	