

# LOUVOLITE PERFECT FIT® SYSTEM

## ROLLER BLIND WITH CHAIN OPERATION

Max width: 1.4m

Max drop: up to 2m (fabric dependant)

Max area: up to 2.8m<sup>2</sup> (fabric dependant)

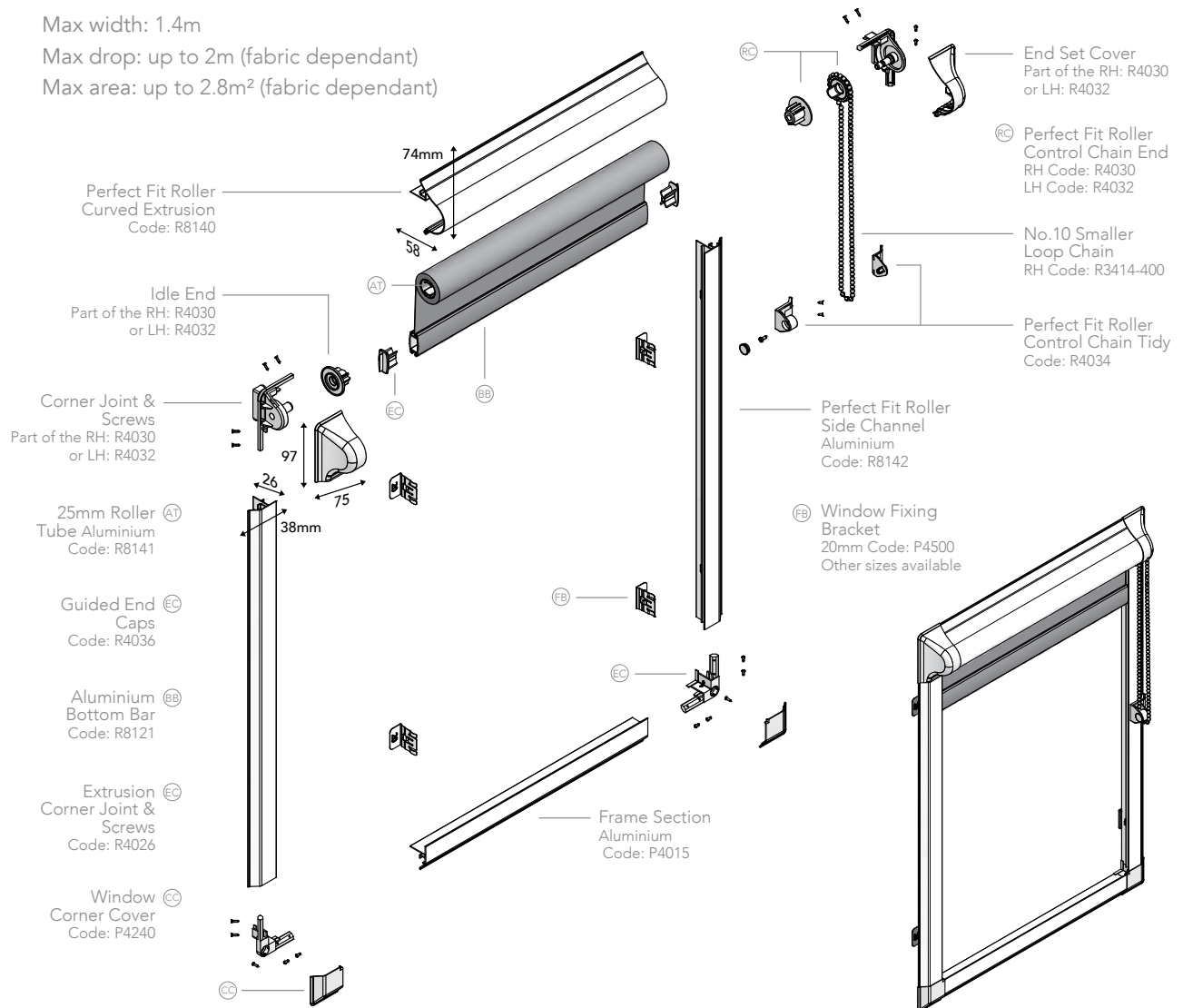

- Designed and manufactured in the UK, all Louvolite systems are 10 year life cycle tested to ensure long lasting performance.
- The blind is housed within a neat frame that clicks into UPVC or timber windows and doors and moves with them when they are opened, tilted or closed.
- No drilling or screwing needed for installation, the frames just click on using the window fixing brackets and can easily be removed for cleaning.
- Reduces the gaps and light strike at the edge of the blind.
- The looped chain, Available as left or Right hand chain operation and is attached to the perfect fit frame with a simple cord tidy (R4034).
- Chain operation is good for doors or hard to reach windows.
- 18, 20, 22, 24, 30 and 38mm brackets to suit most window bead depths.
- End caps with fins keep the bottom bar located in the side channel and away from the window pane.
- Manufactured using high quality engineering grade polymer and aluminium.
- For blinds up to 1.4m wide, with a 2lb maximum holding weight.
- Can be motorised using Louvolite One Touch® Perfect Fit motor (R4045), see reverse.
- Colours available: Extrusion, side channel and frame section: white, brown, anthracite grey, golden oak, mahogany and grey; Endset and window corner cover: white, brown, anthracite grey, tan and grey; Chain: white, brown, anthracite grey and grey; Cord Tidy: white, brown and anthracite grey.

# HARDWARE SPECIFICATION

## System 25® Perfect Fit Roller System

Our roller blinds are manufactured using the Louvolite System 25® roller blind mechanism with specifically designed grooved 25mm aluminium tubing. The specified fabrics are formed and held into the tube with locking tape. The side control units are made from glass filled Nylon 6, with an acetal sprocket and sprocket guard, and includes a locking spring.

The operating chain, No. 10 size in metal or plastic, ensures reliable performance.

The mild steel window fixing brackets are zinc plated and powder coated.

An idle end mechanism is positioned at the opposite end to the control unit, providing a more secure fit of the blind and smooth operation.

### Performance

To ensure a positive performance, all Louvolite System units are designed and manufactured in the UK using prime quality plastic materials and a dedicated steel locking spring.

10 year life cycle testing is done to ensure long lasting performance.

### Operation

All blinds must be compliant with the child safety elements of BS EN13120. Where children may be present, the chain must be fitted with a cord tidy.

### Bottom Bar

Oval, made of aluminium, can be single or double wrapped in fabric or left exposed. All fabric is formed and held into place with locking tape.

Dedicated guide end caps keep the bottom bar in the Perfect Fit side channels and away from the window pane.

### Maintenance

All of the System 25® Perfect Fit roller blind system components are manufactured using aluminium, treated steel and plastic. They do not present any corrosion problems in normal environments. The system has been designed for a smooth operation, together with a rigidity to prolong the window blind's working life.

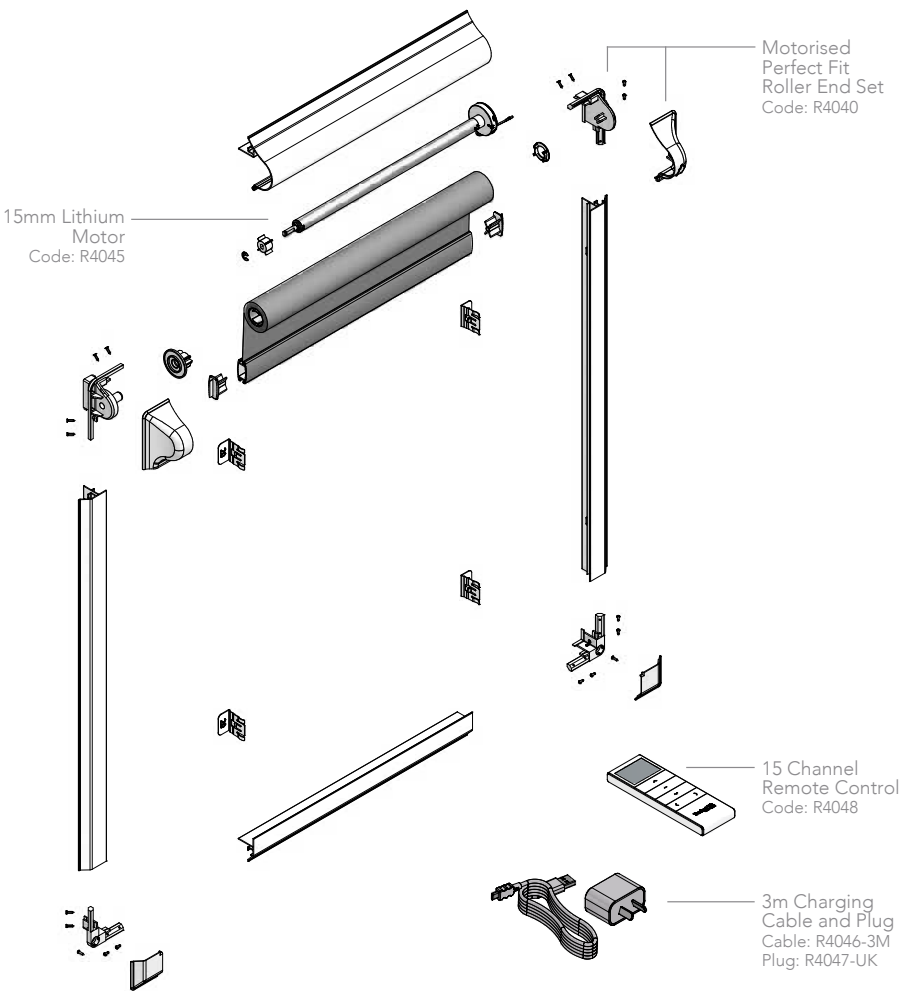

## 15mm LITHIUM MOTOR FOR PERFECT FIT®

PARAMETERS	
Rated Torque	0.3Nm
Rated RPM	30rpm
Motor Diameter	15mm
Rated Voltage	DC5V
Rated Power	5W
Rated Current	0.6A
IP Class	IP20
Inbuilt Receiver	No

FEATURES	
Min Blind Width	400mm
Weight Capacity	1kg
Power Source	Re-chargeable (3m USB cable/ plug charger)

Your Louvolite Perfect Fit® Distributor:



UK MANUFACTURED

[www.louvolitecommercial.com](http://www.louvolitecommercial.com)

CI/SIB 1976 reference by SIB Agency			
(76.7)	X		